

Operator's Manual



Model 3

SAFETY

WARNING

When using electric tools always follow basic safety precautions to reduce the risk of fire, electric shock and personal injury.

Read and save all instructions for future use.

- 1. KNOW YOUR POWER TOOL.** Read this manual carefully and the drill manual, for the drill, used with this Quikpoint Lightning Grouter.
- 2. Do NOT PUT HANDS** in hopper while tool is plugged in or connected to a DC Drill.
- 3. Do not tighten or install parts** while tool is plugged in or connected to a DC Drill.
- 4. DO NOT USE WATER HOSE TO CLEAN TOOL.** (see cleaning instructions)
- 5. In THE EVENT** that tool plugs or jams, do not continue to operate tool.
See trouble shooting.
- 6. Before Operating tool,** be sure nozzle Key Allen Wrench is inserted and locking nozzle holder in place.
- 7. Do not use this tool to dispense materials other than water based cementacious mortars.**
- 8. Do not overreach.** Keep proper footing and balance at all times.
- 9. Do not abuse power cord.** Never carry tool by the drill cord.
- 10. Keep hands away from all moving parts.**
- 11. When not in use, store your tool in a dry secure place. Keep out of the reach of children.**

ACCESSORIES PARTS

- | | |
|--|--|
| 1 - Angled Steel Nozzle #12 | 1 - Scoop 16 oz #36 |
| 1 - Wheel Bolt Set #9 | 1 - 5/16" Ring Clamp Tightener #34 |
| 1 - Drill Mount 4" Ring Clamp #15A | 1 - 7/16" Wrench #35 |
| 1 - Drill Mount 3 1/4" Ring Clamp #15B | 1 - Gibco's MRF 8 oz #33 |
| 1 - 1/8" Allen Wrench Key #10 | 2 - 1/4 X28 x1/4" Socket screw(for Blade coupling) |
| 2 - 1.25" Wheel Washer #7 | 2 - Tip Blade Set (Long & Short Blade) #30 |
| 2 - 1/4" Wing Nut #21 | 1 - U-Blade #31 |

Out of the Box Assembly

Step 1 Push the "Drive Shaft", into the "Wiper Coupling assembly", with the flat facing the Set Screw. Then tighten the socket set screw with the Allen Wrench.

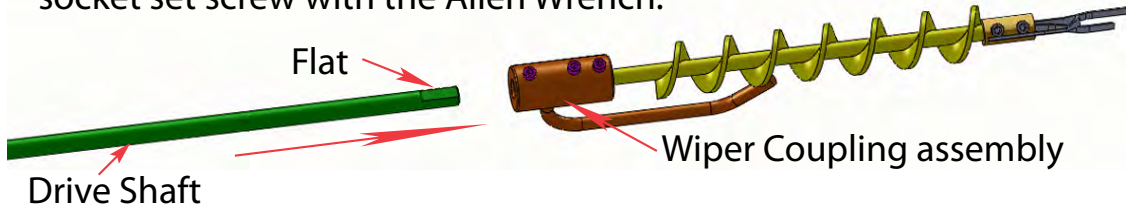

Step 2 Push the Drive Shaft -Auger Assembly into the Tube and then through the "Bearing" as shown. Push the Collar up against the Bearing.

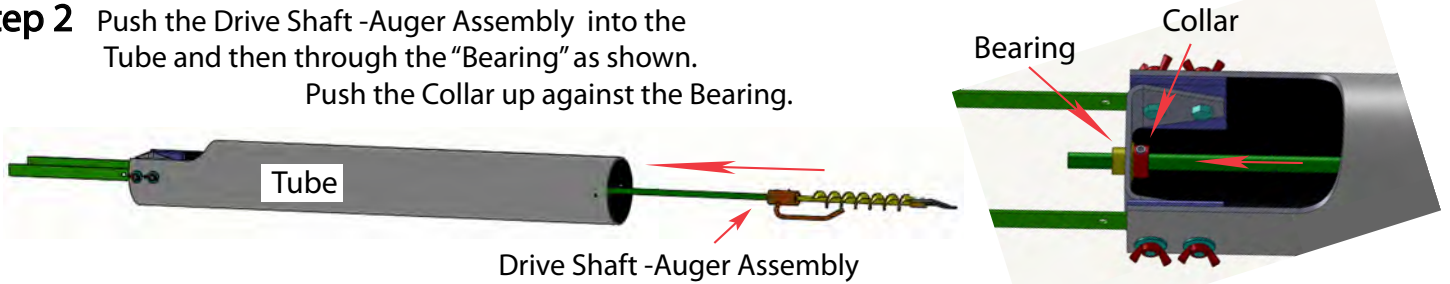

Step 3. A,B,C & D

A. Slide Handle on to Tube.

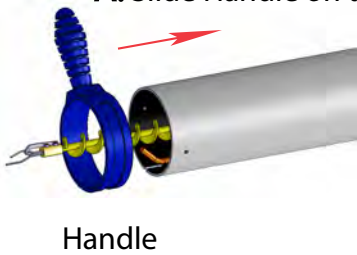

B. Remove Nozzle Holder Assembly from the Cap .

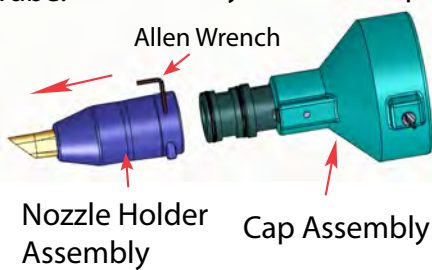

C. Slide Wheel Holder on to the Cap assembly

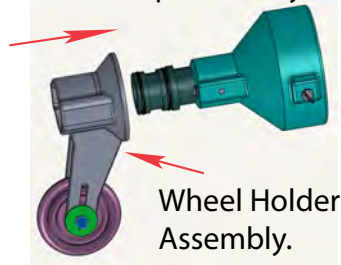

D. Reinstall Nozzle Holder assembly with Allen Wrench

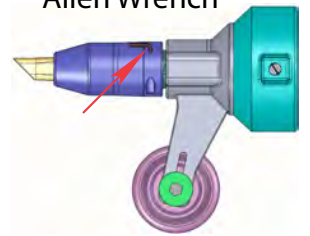

Step 4

Thumb Screw

Slide the Cap assembly on to the front of the Tube assembly. Line up the key in the Cap with the slot in the Tube. Turn in the thumb screws.

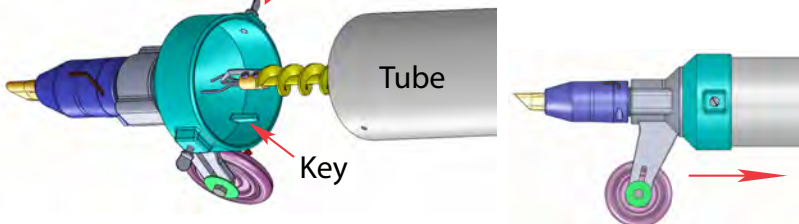

Position the handle , for comfort , then tighten into place with the Ring Clamp Tightener #34



Final Lightning Grouter Assembly.

Step 5

Tightly chuck a drill to the Drive Shaft and use the appropriate Ring Clamp to attach the drill to the Drill Arms. Use the Ring-Clamp tightener (#34)



Collar should be against the Bearing

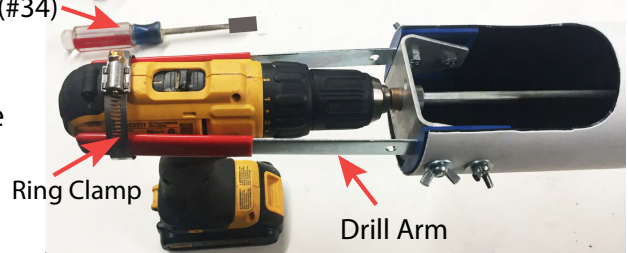

Parts List

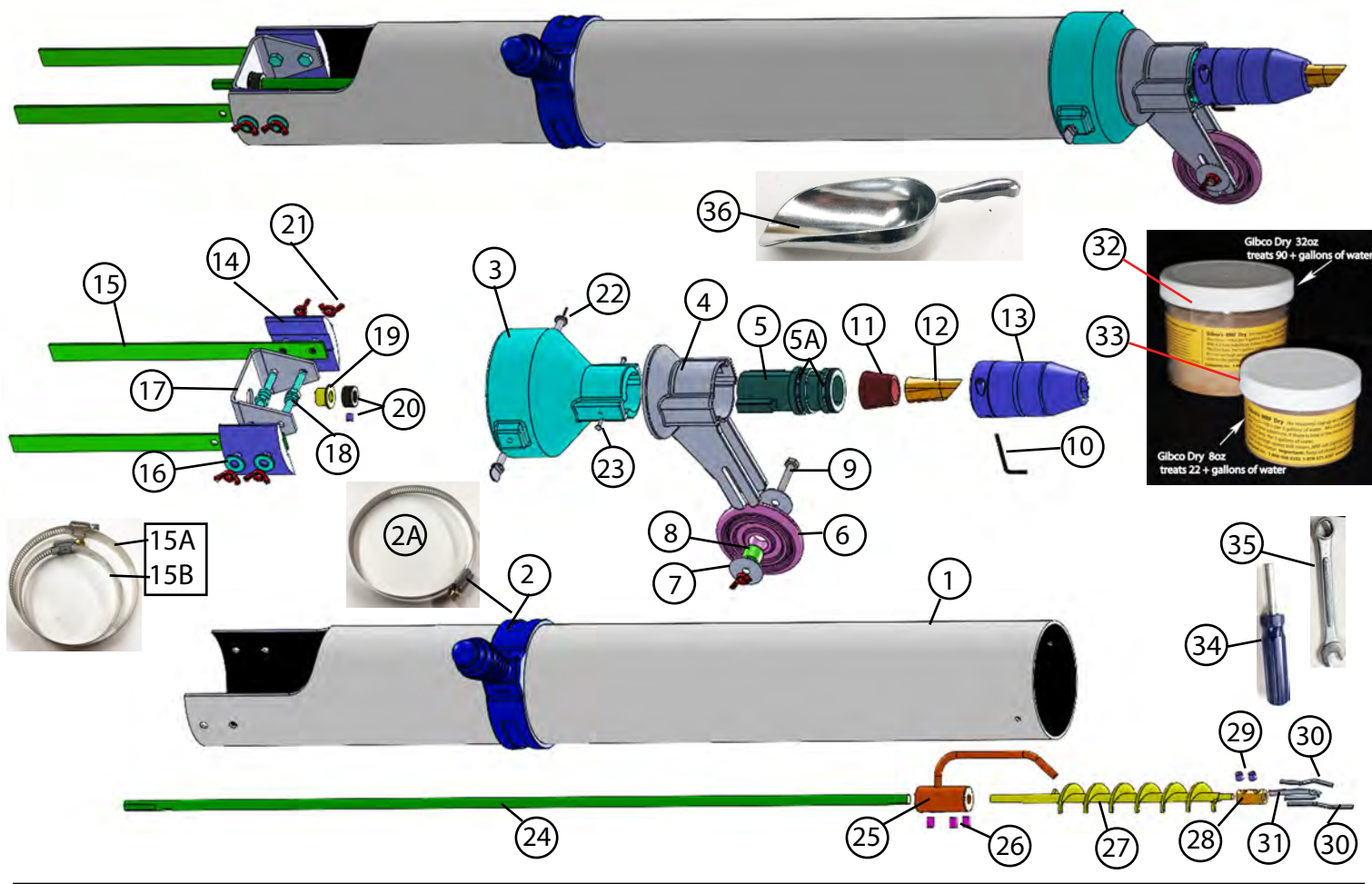

- | | |
|---|------------------------------------|
| 1. Tube | 16. 1/4" Washer (4) |
| 2. Handle | 17. U-Bracket |
| 2A. 4 1/2" Handle Ring Clamp | 18. 1/4-20 X1" Arm Bolts (4) |
| 3. Cap | 19. Bearing |
| 4. Wheel Holder | 20. Collar with Socket screw |
| 5. Auger Barrel | 21. 1/4" Wing Nut (5) |
| 5A. O-Ring (2) | 22. 1/4" Thumb Screw (2) |
| 6. Wheel (2) | 23. Sheet Metal Barrel Screw (2) |
| 7. 1.25 Washer (4) | 24. Drive Shaft |
| 8. Wheel Bushing (5) | 25. Wiper Coupling |
| 9. 1/4-20 X1.5" wheel bolt
(Not shown) 1/4-20 X 2.75" wheel bolt
1/4-20 X 2.25" wheel bolt , 1/4-20 X 4" Wheel bolt | 26. 1/4-20 X 3/8" Socket screw (3) |
| 10. 1/8" Allen Wrench Key | 27. Auger |
| 11. Nozzle Retainer | 28. Blade Coupling |
| 12. Angled Nozzle | 29. 1/4-28 X 1/4" Socket screw (2) |
| 13. Nozzle Holder | 30. Long & Short Tip Blade set |
| 14. Drill Arm Mount (2) | 31. U-Blade |
| 15. Drill Arm (2) | 32. Gibco's MRF 32oz |
| 15A. Drill Mount 4" Ring Clamp | 33. Gibco's MRF 8 oz |
| 15B. Drill Mount 3 1/4" Ring Clamp | 34. 5/16" Ring Clamp tightener |
| | 35. 7/16" Wrench |
| | 36. Scoop 16 oz |

Loading and Operation

To Load the Grouter, Use the included 16oz Scoop (#36). Hold the Grouter as shown. We recommend elevating the Mortar tray for easier loading.



For ease of handling, We recommend loading the Grouter to a level no higher than the Top of the yellow label.



Fill to about this level, Approximately 3" from edge of the opening.



The Grouter can also be supported on something like a saw-horse to be loaded etc.



Run a small amount of material out to prime.

Adjust the Handle position for best comfort. Use the Ring-Clamp Tightener (#34) to Secure



Draw the Grouter back in the joint. Keep the Steel Nozzle slightly in the joint



Do not run the Drill too fast for best control.

Cleaning

To Clean, pour water into the Grouter and run the drill in forward and reverse. Add water until the water is clear coming out of the nozzle.



Clean all (mating) surfaces in the Nozzle Holder, Steel Nozzle, Nozzle Retainer and Auger Barrel.
If all surfaces are not cleaned the Allen Wrench Key will not secure the Nozzle Holder correctly to the Auger Barrel.

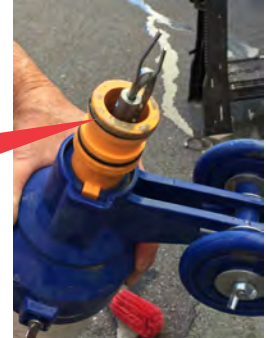

To remove the Wheel Assembly, remove the Nozzle Holder then slide the Wheel Assembly off.

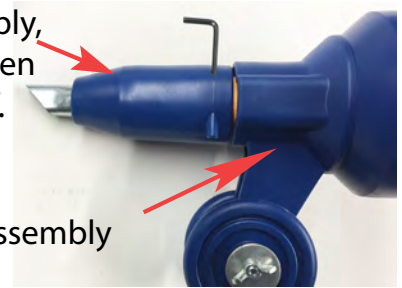

Wheel Assembly

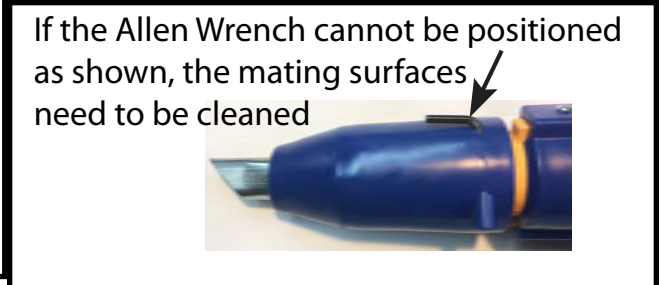
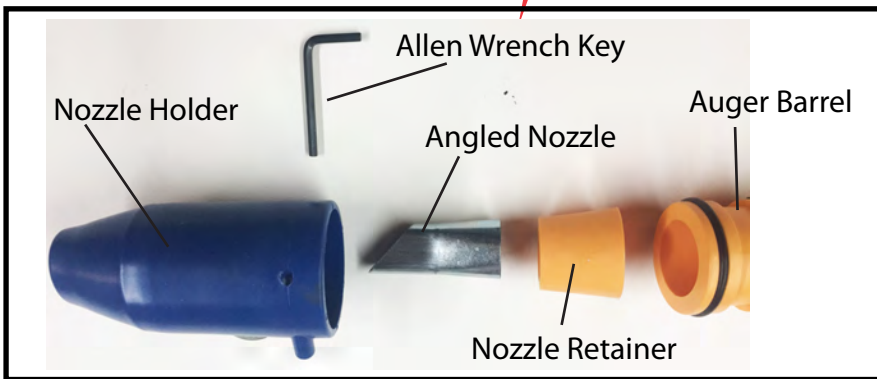

"Drill Arm", "U-Bracket" and "Drill Arm Mount" Assembly.

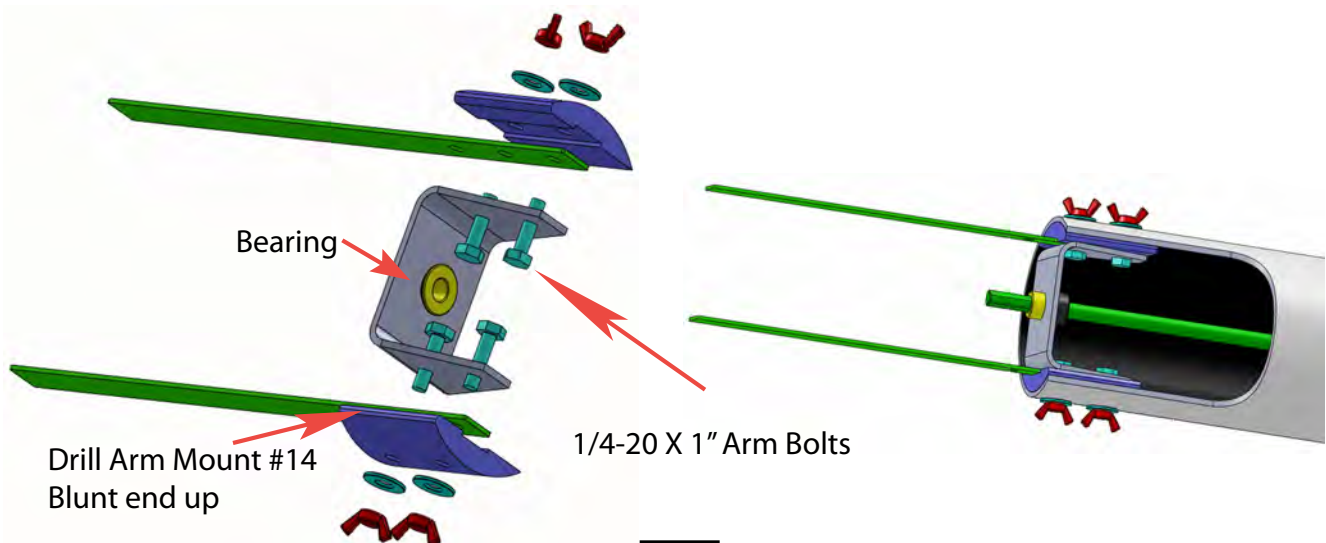

4 Wheel Configurations.

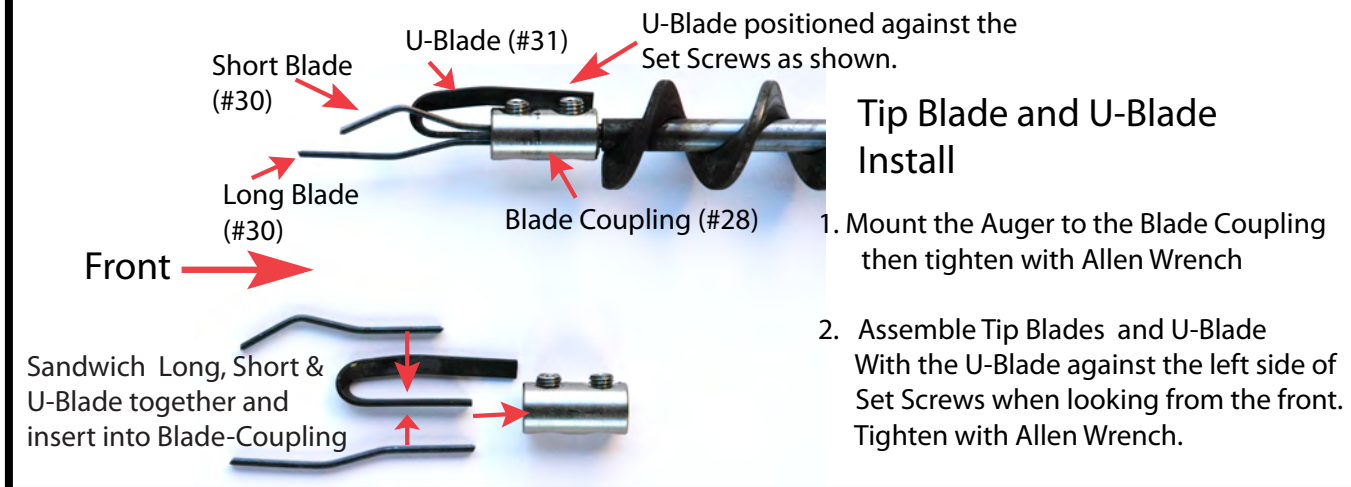

Insert the Auger (#27) into the Wiper Coupling (#25) so that the edge of the Flat is flush with the face of the Wiper Coupling.

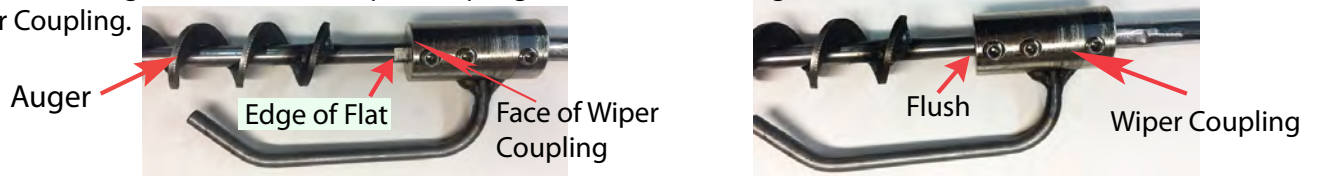

Slide the Allen Wrench into the Nozzle Holder to key on to the Auger Barrel

Cap, Nozzle Holder and Auger Barrel Assembly

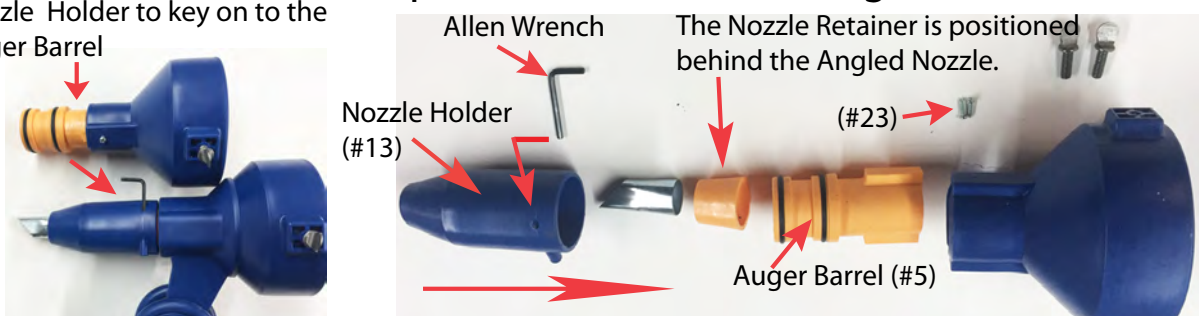

MORTAR MIXES

The Quikpoint Grouter works well with all standard U.B.C.(universal building code) mortar mixes up to 2 1/2 parts fine sand by volume to one part by volume of the cements plus lime used.

Example of a 2 1/2 to 1 Mix

$$\begin{array}{r} 1\text{- Cement} \\ +1\text{- Lime} \\ \hline = 2\text{ parts by volume} \\ \times 2\ 1/2 \\ \hline = 5\text{ parts sand by volume} \end{array}$$

Example of a 2 to 1 Mix

$$\begin{array}{r} 1\text{- Cement} \\ +1\text{- Lime} \\ \hline = 2\text{ parts by volume} \\ \times 2 \\ \hline = 4\text{ parts of sand by volume} \end{array}$$

The strength or P.S.I. of a mix is varied by the type of cement used and the volume of cement, lime and fine sand used.

For best results the aggregate (fine sand) should not have particles larger than 1/8 inch.

1. A richer mix (less sand) will move more easily through the Grouter.
(we recommend mixing a small experimental batch of mortar to see how your mix works in the grouter)
2. If your Mortar Mix is plugging or the Drill is laboring try adding the Gibco's-MRF additive.
the Gibco's additive is available from Quikpoint in 8oz and 32oz containers.

Gibco's-MRF will also reduce wear in the Quikpoint Grouter. See Gibco's flier page 7 & 8.

- A. Add Gibco's Dry MRF to water 1/4 to 3/4 Table Spoons per 1 gallon of water.
Do not exceed 4 Table Spoons per 5 gallons of water. (We include a Tablespoon measuring scoop)
- B Gibco's MRF is a Lime substitute. If there is Lime in the mix reduce the amount of Gibco's MRF to 1/4 to 1/2 Table Spoon per 1 gallon of water or approximately 1 1/4 to a maximum of 2 1/2 Tablespoons per 5 gallons of water.
- C Do not use high speed drill mixers. Gibco will slightly air entrain and may alter (lighten) color in the mix.
- D If you are patching into an existing job, we recommend applying the Gibco mix to a trial area to see how the color matches the existing mortar. Allow to set overnight before comparing color.

Gibco's Dry MRF is available through Quikpoint, Inc.

**IF THE QUIKPOINT GROUTER IS LABORING OR PLUGGING
it is HIGHLY RECOMENDED
with any mortar mix to use the GIBO'S-MRF additive**

GIBCO'S-MRF

BUILDING THROUGH TECHNOLOGY



EASY TO USE

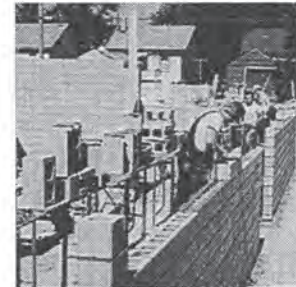

SUPERB WORKABILITY



COMPLETED PROJECT



COMPLETED PROJECT

OTHER ADVANTAGES

- Greater Resistance to Freeze & Thaw
- Reduced Shrinkage of Mortar
- Less Storage & Handling
- Reduced Clean-up Cost
- Less Call Backs
- Replaces Lime & Other Additives
- Reduced Water Penetration
- Reduces Efflorescence
- Lower Batch Cost
- Avoids Waste

23B Bradford Street
Concord, MA 01742
Fax: (978) 371-2292
Phone: (978) 371-3267



TOLL FREE
1-800-368-2292
U.S. and Canada

GIBCO'S MRF

... building progress through technology

Gibco's MRF the "pure" catalytic chemical concentrate that does the *whole job* ... alone! No need for lime or other hard to control additives! / MRF produces superior mortars at substantial savings in time and expense. / MRF mortars are high strength, virtually waterproof and colorfast without disbonding. / MRF established "state-of-the-art" technology for the masonry industry. / MRF chemical concentrate solves the problems of excess tempering, efflorescence, freeze-thaw breakup, water penetration and lime burns. / MRF mortars meet or exceed design specifications.

SAVE THREE WAYS WITH MRF

MRF is a substitute for water active ingredients traditionally used ... provides a nonshrinking mortar after initial set.

FREEZE-THAW DAMAGE ELIMINATED ... COMPARED WITH OTHER MORTAR MIXES

More resistant to freeze-thaw cycles than lime mortar ... consistent 12 to 14 percent air entrainment without hard to control A/E chemicals.

INCREASED STRENGTH ...

MRF is the catalyst that maximizes the effectiveness of cement and results in twice the compressive strength of lime mortars. MRF's high water retention assures strength and helps waterproofing qualities.

COLOR CONSISTENCY WITH ONE-THIRD LESS COST

Use one-third less color pigment to achieve the same color brilliance. MRF's unique, dispersing agent homogenizes the sand, cement and pigment to form a mortar alloy never before possible.

Get color consistency ... batch to batch ... day to day ... even crew to crew, all without weathering or fading!

SUPER WORKABILITY ... WITHOUT EXCESS TEMPERING

Easy tooling of joints ... even spread and buttering ... stays with brick, block and stone! MRF retains over 80 percent of mix water and remains workable longer without retempering or loss of strength.

NO MORE LIME BURNS OR SKIN IRRITATION

MRF's lime-free mortar creates a safer jobsite and better working environment. Ends time loss and medical claims caused by lime mortars.

23B Bradford Street
Concord, MA 01742
Fax (978) 371-2292
Phone (978) 371-3267

SOLVES SHRINKAGE PROBLEMS

Time ...

MRF produces a fully homogeneous mortar, easily mixed, a pleasure to apply. Man-hour length requirements are reduced.

Materials ...

A small amount of MRF goes a long way in replacing a ton of lime.

Easy to store and safe to handle in convenient plastic containers ... unlike heavy, hazardous bags of lime. Use 25% more sand without a change in mix integrity.

Money ...

You'd expect to pay more for a product with all the features of MRF ... but *MRF costs less* than any lime mortar you're using ... as much as 50 percent less! *Plus*, MRF reduces labor, waste and cleanup as much as 30 to 40 percent.

INDEPENDENT LABORATORY TESTS SHOW GIBCO'S MRF STANDS ALONE

TEST	TYPE	MRF	ASTM STANDARD
ASTM C185	Air Content	12%	8% to 20%
ASTM C109	Compressive Strength	3000 to 8000 psi	2900
ASTM C157	Shrinkage Test	.01	.10
ASTM C109	Flow	111	115 + or -
ASTM C109	Water Retention	80 to 85	70 min
ASTM C151	Autoclave Soundness	.011	1.0 max
ASTM C1072	Flexural Bond Type S	139.97	104 min
ASTM C1072	Flexural Bond Type M	148.16	114 min

Please call for test packets or spec sheets available upon request.



TOLL FREE
1-800-368-2292
U.S. and Canada

TROUBLE SHOOTING

1. The Drill is turning but the Grouter is not delivering mortar out of the Nozzle.
 - A. Make sure the drill is in forward rotation. The tool will not deliver mortar in reverse.
 - B. Make sure set screws on the Wiper Coupling, Blade-Coupling and Collar are tight.
 - C. Inspect auger for wear. Take the Nozzle-Holder off and look down the inside of the Barrel. If there is a gap of 1/8th inch or more around the Auger then the Auger (#27) needs to be replaced. If the Auger is not worn and there is a similar gap then the Auger-Barrel (#5) needs to be replaced.
 - E. If none of the above applies then remove the Auger and inspect the weld between the auger flight and the center shaft. These welds can break if the Auger is jammed.

2. The tool plugs

- A. Check to see that the Nozzle-Holder, Steel nozzle and plastic Retainer are assembled in the correct order. The steel nozzle is inserted first followed by the Retainer. See Page 5
 - B. If tool plugs remove the Nozzle-Holder. Holding Nozzle-Holder with the Steel Nozzle up hit back of Nozzle-Holder on hard surface to remove stiff mortar. Keeping hands away from Tip-Blades run drill in forward to dislodge any obstructions in the Auger-Barrel. Clean the end of the Auger-Barrel and Nozzle-Holder assembly with water. Reinstall Nozzle-Holder and run. See Page 4
 - C. If problem continues, check the Tip Blades(#30) and U-Blade(#31) for wear. The Long-Blade should be no more than 1/2 inch back from the front of the Steel-Nozzle. If wear is noted, replace worn parts.
Note: The U-Blade(#31) usually does not have to be replaced until 3 or 4 sets of Tip-Blades(#30) have been replaced. See Page 5
 - D. If Problems persist see, mortar mix information page 6
3. If The Nozzle-Holder rotates during operation, check to see if the position of the Long Tip Blade and bottom edge of the Angled Nozzle are as seen in this picture. If not, see page 5 (insert Auger) and page 1 (Step 2). If the Tip Blades are too far forward, they can grab the Steel Nozzle and turn the Nozzle assembly.

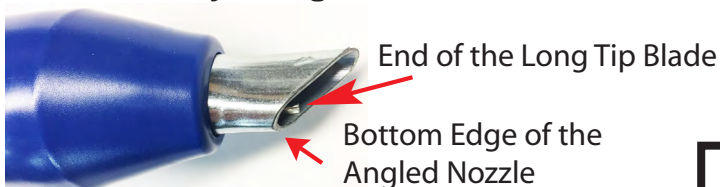

LIMITED WARRANTY

This product is warranted by Quikpoint Inc. to the original purchaser to be free from defects in material and workmanship under normal use for a period of one year from the date of purchase.

Every Quikpoint tool is thoroughly inspected and tested before leaving our manufacturing facilities. Should any trouble develop, return the complete tool prepaid to our corporate office. If inspection shows the trouble is caused by defective workmanship or material, all repairs will be made without charge and the tool will be returned, transportation prepaid.

This warranty does not apply where 1.) repairs are required because of normal wear, 2.) the tool has been abused or involved in an accident; 3.) misuse is evident, such as caused by overloading the tool beyond its capacity; 4.) the tool has been used with an improper accessory.

No other warranty written or verbal is authorized.

This warranty gives you specific legal rights and you may also have other rights which vary from state to state.



23 B Bradford St.
West Concord, MA 01742

Tel. 1-800-368-2292

Fax. 978-371-2292